

Transition Fitting PE-100/Steel



- PE-100-SDR 11/17 (17,6)
- with long PE-100 coated St 37 steel welding end and with welding bevel acc. to DIN 2559/22
- steel-end DN 80-300, larger dimensions up to DN 500 on request
- PE-100 end sufficiently long for the use of electro fusion sockets
- d3 acc. to EN 10208-1 with welding bevel acc. to DIN EN ISO 9692-1 type 22
- high safety and long service live due to solid construction and the use of voluminous Tyton sealing rings
- 3.1 certificate acc. to DIN 10204 available
- DVGW approval DV-7521BQ0469 except items marked *

- A PE coated steel welding end
- B gasket against penetrating moisture
- C interlocking toothring
- D gasket against internal pressure

Options

- short steel welding end for valves
- for flange acc. to DIN 2633
- welding neck flange acc. to DIN 2633
- Stainless Steel 1.4571 or 1.4301
- d1 connection acc. to DIN 2470 part 1, with welding bevel acc. to DIN 2559/22

SDR 11, 17/17,6

DN	d1	d3	le1	le3	D	Z	KG
80	90	88,9	150	80	135	610	5,5
80*	110	88,9	150	80	135	635	5,6
100	110	114,3	170	80	170	630	8,5
100	125	114,3	160	80	170	665	8,6
150	160	168,3	210	80	240	715	17,5
150	180	168,3	190	80	240	805	17,7
200	200	219,1	177	80	300	780	27,0
200	225	219,1	250	85	300	800	26,5
250*	250	273,0	177	81	380	845	34,7
250*	280	273,0	175	81	380	825	33,1
300*	315	323,9	175	80	430	865	43,1

* without DVGW approval

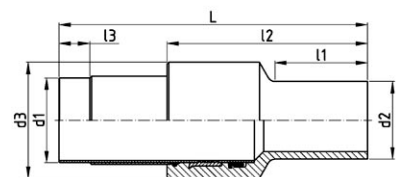

DN 80 - DN 200

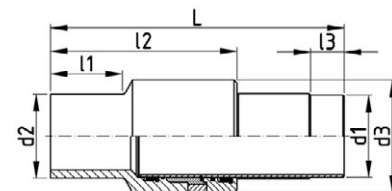

DN 250 - DN 300

Transition fitting PE-100 / Ductile Iron
pull-out resistant, Type 2
patented



- PE-100 - SDR 17 / 11, pull out resistant
- DN 80 - DN 200, larger sizes on request
- socket with external Stainless Steel reinforcing ring
- with 2 screw-rings, clamping rings, slide and sealing rings
- with Tyton sealing EPDM gasket
- PE end for electro fusion
- not suitable for Gray Iron (C.I.) pipe systems
- for gas application and other media only on request

Please observe the installation guide for Ductile Iron (D.I.) pressure pipes and fittings, also for our screwed Ductile Iron (D.I.) sockets

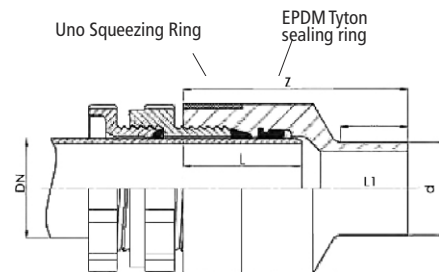
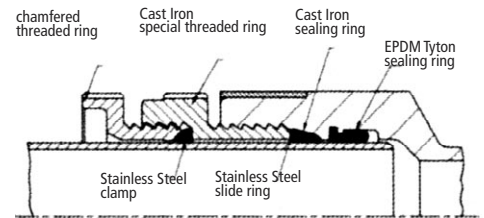

SDR 11, 17/17,6

DN	d1	l1	L	Z	KG
80	90	80	130	250	3,5
100	110	90	140	285	4,2
100	125	100	140	285	4,7
150	160	110	170	330	5,6
150	180	110	170	330	6,3
200	225	130	200	370	7,0

Transition Coupling PE-100/PVC-U with Cast Iron clamp

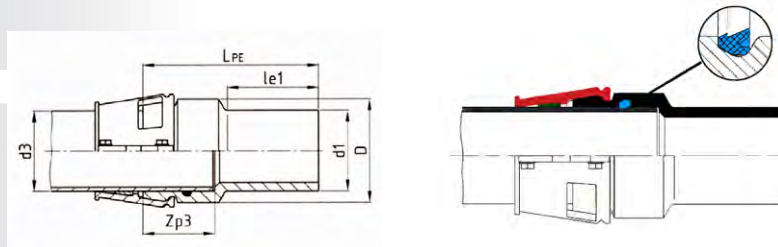

- PE-100, SDR 11 / 17 with Cast Iron pull-out resistant clamp and Stainless Steel screws
- d 90 - 315 mm (other dimensions on request)
- PVC-U push-fit end DN 80 - DN 300
- PE100 push-fit socket for electro welding and EPDM lip seal ring Type 3S with KTW recommendation for drinking water
- resistant to longitudinal forces
- optional without pull-out resistant coupling

SDR 11, 17/17,6

DN	d1	d3	le1	zp3	D	LPE	KG
80	90	90	80	172	135	280	1,5
100	110	110	90	174	159	290	2,1
100	125	110	100	174	159	300	2,2
125	140	140	110	200	185	345	3,1
150	160	160	110	225	220	380	4,9
150	180	160	110	225	220	365	4,3
200	225	225	130	215	290	380	7,4
250	280	280	200	215	355	490	12,7
300	315	315	200	295	400	580	19,1

DN = PVC-U end d = outer diameter
other types, sizes and length on request

Transition fitting PE-100 - Clay

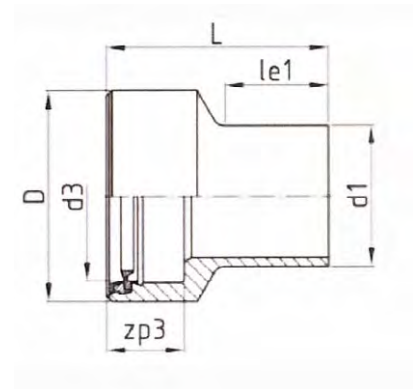

- for transition from clay pipes at standard load series to PE pipe systems
- PE-100 body with socket
- DN 150 - 200 with fixed clay standard lip seal gasket
- DN 250 - 350 with lip seal gasket acc. to DIN 4034-1

SDR 11, 17/17,6

DN	d1	d3	le1	zp3	D	L	KG
150	160	193	110	85	240	250	3,1
200	200	249	130	85	300	270	4,5
200	225	249	130	85	300	270	4,8
250	250	296	200	100	360	390	8,9
250	280	296	200	100	360	390	9,7
300	315	350	200	100	420	400	13,9
350	355	404	200	100	490	450	17,3

Spigot End

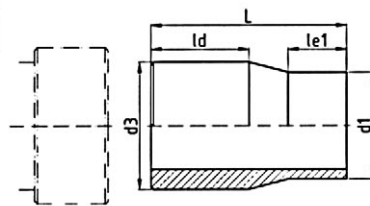

SDR 11, 17/17,6

DN	d1	d3	le1	ld	L	KG
100	110	131	100	100	230	1,2
100	125	159	100	100	230	1,9
125	140	159	110	100	240	1,7
150	160	186	110	100	240	2,5
150	180	186	120	100	240	2,2
200	200	242	130	100	270	4,7
200	225	242	130	100	270	4,2
250	250	296	140	100	280	7,1
250	280	296	150	100	280	6,7
300	315	350	160	100	290	10,1
350	355	350	170	100	300	8,6

Transition fitting PE-100 / Ductile Iron pull-out resistant, Type 3

- SDR 17/11, pull out resistant
- one end with our PE repair socket
- other end with Ductile Iron (D.I.) screwed socket
- EPDM Tyton gasket
- socket with external Stainless Steel reinforcing ring
- delivery incl. special screw-, clamping-, slide- and sealing rings
- other sizes and/or for gas application on request

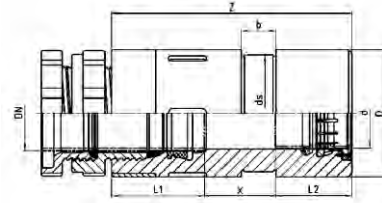

DN	d	ds	b	Z	KG
80	90	164	45	360	8,5
100	110	184	55	380	9,5
100	125	184	55	390	9,0
150	160	230	55	420	16,0
150	180	244	55	440	17,5
200	225	300	55	480	26,0

Push-Fit Transition Coupling for PE-100/PVC-U water pipes up to 16 bar patented

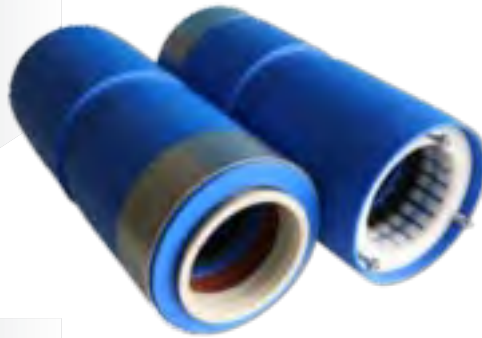

- PE-100 / PVC-U **pull-out resistant** long type Push-Fit Transition Coupling for PE-100 and PVC-U water pipes up to 16 bar
- d 90 - d 160, SDR 17/11
- body PE - 100 RC*
- PVC-U end with corundum clamp ring and push-in aid and external Stainless Steel reinforcing ring
- PE-100 end with POM Grip-Ring, 3 Stainless Steel tensioning screws at the front side for safe pre-stressing and restraining the Grip Ring
- EPDM lip seal ring Type 3S with KTW recommendation for drinking water
- resistant to longitudinal forces due to resilient POM Grip Ring

* RC = crack resistant

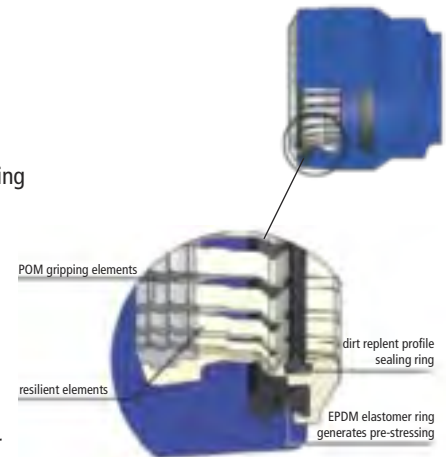

SDR 11

DN	d1	d3	zp1	zp3	x	d	L	KG
80	90	90	150	150	95	152	422	3,1
100	110	110	152	152	95	175	425	3,7
150	160	160	164	164	115	234	425	7,0

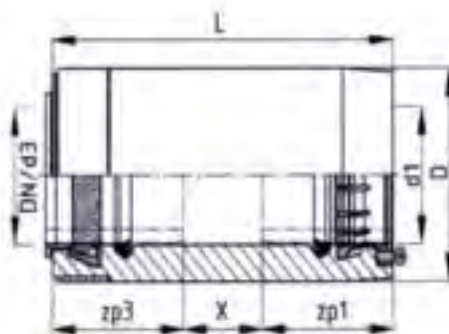

Tolerance
 $X \pm 5 \text{ mm}$

1. chamfer pipe 15°



2. push fitting over pipe

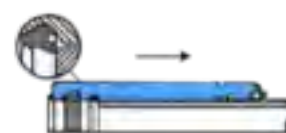

3. push fitting back



4. tightening screws



Push-Fit Coupling with Flange, PE-100 patented



- PE-100 **pull-out resistant** Push-Fit Coupling with RILSAN coated HP Flange DIN EN 1092-1, PN10 for connection, repair and transition of PE-100 water pipes up to 16 bar (for gas pipes on request)
- d 90 - d 225, DN80 to DN150 / PN10 & 16, DN200 PN10, PN16 on request
- body PE-100 RC*
- with POM Grip - Ring
- EPDM lip seal ring Type 3S with KTW recommendation for drinking water
- resistant to longitudinal forces due to resilient POM Grip Element
- dirt repellent profile ring
- DVGW approved for drinking water, Reg.-No. DW-8616BU0210, DV-4508BO0259

* RC = crack resistant

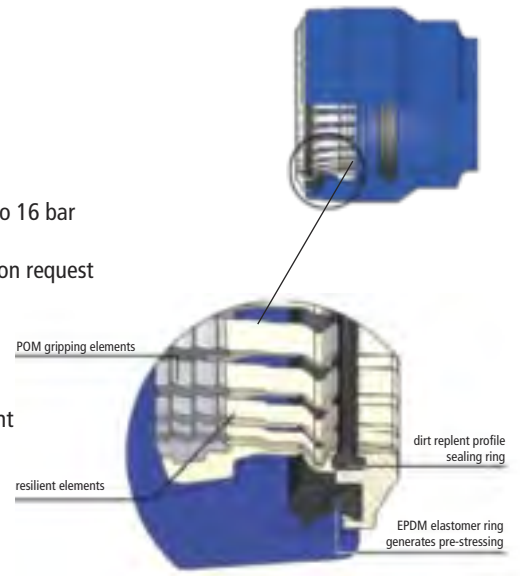

SDR 11, PN16

DN	d1	zp1	øK	n x øL	Bolts	hF	D	L	KG
80	90	140	160	8x18	M16	29	200	240	4,4
100	110	145	180	8x18	M16	31	220	250	5,8
100	125	148	180	8x18	M16	38	220	255	6,5
150	160	163	240	8x22	M20	42	285	275	12,1
150	180	185	240	8x22	M20	47	285	285	13,4
200	200	213	295	8x22	M20	50	340	285	14,5
200	225	216	295	8x22	M20	50	340	360	22,5

flange DIN EN 1092-1, PN 10

