

Ball Valves PVC-U

with EPDM O-rings, ball flush out secured threaded / socket

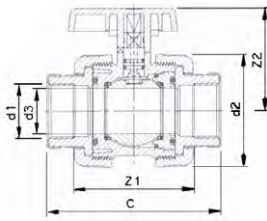

Type A



Type B

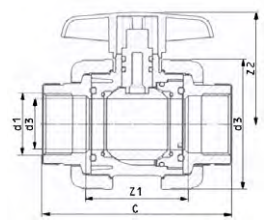

Type	DN	d1	d2	d3	Z1	Z2	C	PN	pc/box
A	10	3/8" (F)	59	15	52.0	50	84	16	50
A	15	1/2" (F)	59	15	52.0	50	84	16	50
A	20	3/4" (F)	64	20	59.0	55	93	16	50
A	25	1" (F)	73	25	66.0	65	108	16	50
A	32	1 1/4" (F)	86	32	76.0	75	122	16	25
A	40	1 1/2" (F)	102	40	102.0	90	148	16	15
A	50	2" (F)	124	50	107.0	103	175	16	10
B	65	2 1/2" (F)	151	63	144.0	123	216	10	5
B	80	3" (F)	178.5	75	178.0	143	256	10	3
B	100	4" (F)	215.5	90	214.0	161	306	10	1

Ball Valve type ISO Top

with EPDM and Viton® O-rings

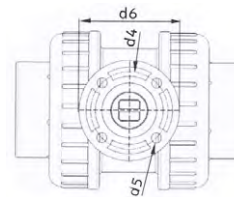
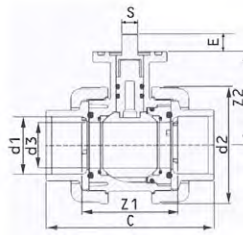

DN	d1	d2	d3	Z1	Z2	C	PN	Torque	pc/box
25	32	73	25	63	60.5	108	16	4.5 Nm***	12(6x2)*
40	50	102	40	85.5	81.5	148	16	7.5 Nm***	6 (6x1)**
50	63°	124	50	101	93.5	178	16	on request	on request

DN	d1	d4	d5	d6	E	S	ISO 5211
25	32	42	5.5	54	11	11	ISO 5211-F04-Y-L-11
40	50	50	6.5	65	15	14	ISO 5211-F05-Y-L-14
50	63°	50	6.5	65	15	14	ISO 5211-F05-Y-L-14

° d63 with mounting plate

* packed separately per 2 pieces in a box containing 12 pieces

** packed separately per piece in a box containing 12 pieces

*** Average value at nominal pressure;

the torque of the actuator should be about 2x as high as the average torque value from the Ball Valve to take into account the influence of operating conditions.

The exact factor depends upon the application.