

# Angle Seat Valve

## DN 15 - DN 50

PVDF



**KONEX**  
INTERNATIONAL

- slow opening / close valve, prevent water hammer
- PVDF, PVC and PP on request
- PN 16
- DN 15 - DN 50

Diameter			Dimensions									KV-value p=1bar			
d	DN	inch	Z	H	H1	L	L1	L2	L3	L4	D	LK	D1	n x d2	l/min
20	15	½"	36	115	135	130	140	168	238	124	42	65	95	4 x ø 14	95
25	20	¾"	36	115	135	150	160	192	264	144	48	75	105	4 x ø 14	180
32	25	1"	41	126	143	160	170	206	280	154	68	85	115	4 x ø 14	327
40	32	1¼"	45	160	182	180	190	230	306	174	85	100	140	4 x ø 18	484
50	40	1¼"	51	174	204	200	210	256	332	194	85	110	150	4 x ø 18	725
63	50	2"	60	209	246	230	240	294	368	224	102	125	165	4 x ø 18	1130

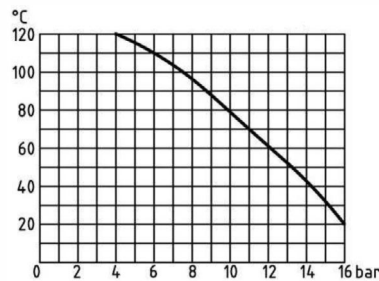
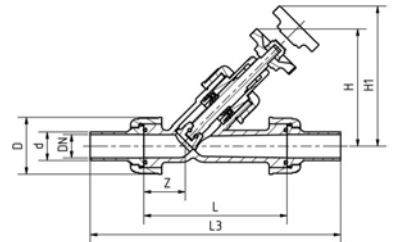
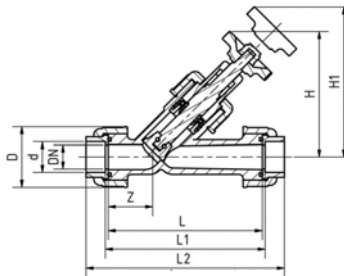
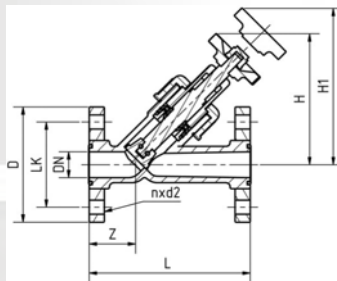

No.	description	material
1	body	PVC, PP, PVDF
2.1	union end, butt welding	PP, PVDF
2.2	union end, socket weld	PVC, PP, PVDF
2.3	flange	PVC / GRP
3	connection nut	PVC, PP, PVDF
4	O-ring	EPDM, FPM
5	cup nut	PVC, PP, PVDF
6	valve disc	PB, PVDF
7	supporting ring	PVC, PP, PVDF
8	collar	PB, PTFE
9	stem	PVC, PP, PVDF
10	clamp	PVC, PP, PVDF
11	spindle carrier	PVC, PP, PVDF
12	hand wheel	Bakelite
13	cup nut	PVC, PP, PVDF

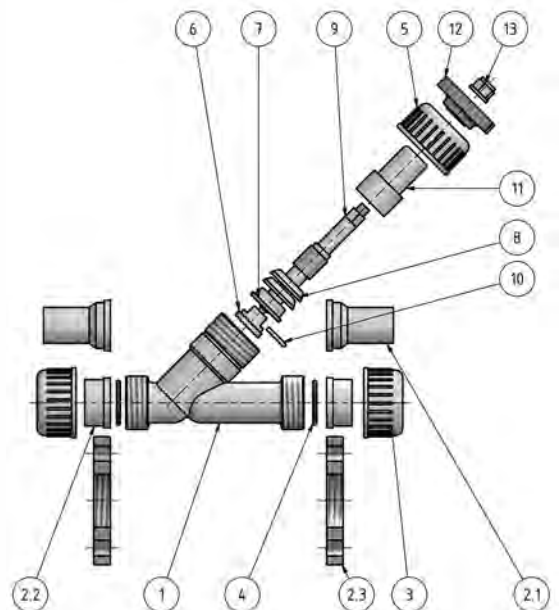

# Angle Seat Valve

DN 15 - DN 50

PVDF

**KONEX**  
INTERNATIONAL



## PVDF, EPDM

d	DN	inch	PN	GRP flanges srewed		union ends butt welding		union ends socket welding	
				No	KG	No	KG	No	KG
20	15	½"	16	479803	0,53	479809	0,39	479815	0,37
25	20	¾"	16	479804	0,63	479810	0,46	479816	0,44
32	25	1"	16	479805	0,84	479811	0,61	479817	0,58
40	32	1¼"	16	479806	1,41	479812	1,03	479818	0,98
50	40	1½"	16	479807	1,93	479813	1,45	479819	1,36
63	50	2"	16	479808	2,85	479814	2,32	479820	2,25

PB collar on request

GFK/FRP flanges DIN 2501 / EN 1092-1

## PVDF, FKM

d	DN	inch	PN	GRP flanges srewed		union ends butt welding		union ends socket welding	
				No	KG	No	KG	No	KG
20	15	½"	16	472297	0,53	472291	0,39	479429	0,37
25	20	¾"	16	472298	0,63	472292	0,46	479430	0,44
32	25	1"	16	472299	0,84	472293	0,61	479431	0,58
40	32	1¼"	16	472300	1,41	472294	1,03	479432	0,98
50	40	1½"	16	472301	1,93	472295	1,45	479433	1,36
63	50	2"	16	472302	2,88	472296	2,32	479434	2,25

PB collar on request

GFK/FRP flanges DIN 2501 / EN 1092-1