

Elbow 90° PVC-U

Type A

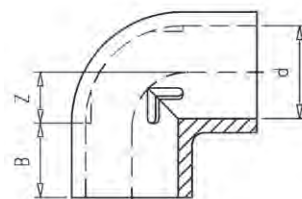

Type B

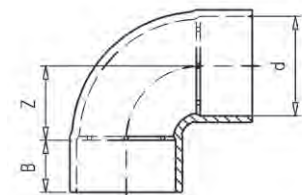

Type A $r = 0,5 d$
 Type B $r = 0,75 d$

d1	Z	B	PN	Type	pc / box
10	6.0	12	16	A	250 (5 x 50)
12*	7.0	12	16	A	250 (5 x 50)
16*	9.0	14	16	A	250 (5 x 50)
20*	11.5	16	16	A	200 (4 x 50)
25*	14.0	19	16	A	350
32*	18.0	22	16	A	250
32	18.0	22	10	A	250
40*	22.0	26	16	A	175
40	22.0	26	10	A	175
50*	27.5	31	16	A	100
50	27.5	31	10	A	100
63*	32.5	38	16	A	50
63	32.5	38	10	A	55
75	38.5	44	16	A	30
75	38.5	44	10	A	30
90	46.0	51	16	A	17
90	46.0	51	10	A	17
110	60.0	61	16	A	12
110	60.0	61	10	A	12
125	63.5	69	16	A	6
140	71.0	76	16	A	5
160	83.0	87	16	A	2
200	106.0	107	10	A	1
225	118.5	120	10	A	1
250	131.0	132	10	A	1
280	210.0	147	10	B	1
315	237.0	165	10	B	1
400	300.0	207	6	B	1

* kiwa standard PN16

Elbow 90° PVC-U reduced

Type A

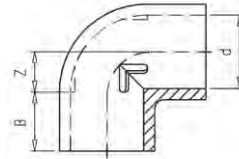

Type B

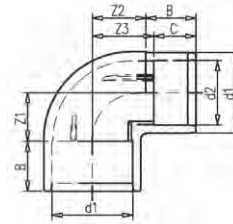

d1	d2	Z1	Z2	Z3	B	C	PN	Type	pc/box
40	32	22.0	22	-	26	22	10	A	200
50	32	28.0	33	-	31	22	10	A	150
50	40	28.0	29	-	31	26	10	A	135
50	40	30.0	33	38.0	31	26	10	B	100
63	50	45.5	44	50.5	37.5	31	10	B	50

Elbow 45° PVC-U reduced

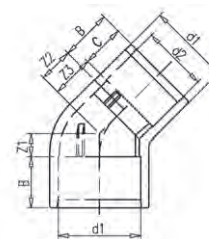

d1	d2	Z1	Z2	Z3	B	C	PN	pc/box
50	40	14.0	21.0	26.0	31.0	26.0	16	100
63	50	17.5	26.5	32.5	37.5	31.5	16	50

Elbow 90° PVC-U

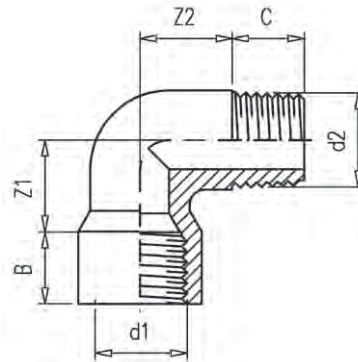

d1	d2	Z1	Z2	B	C	PN	pc/box
1/2" (F)	1/2" (M)	20.5	20.5	16.0	16.0	10	200
3/4" (F)	3/4" (M)	24.5	24.5	17.0	17.0	10	300
1" (F)	1" (M)	30.0	30.0	21.0	21.0	10	200

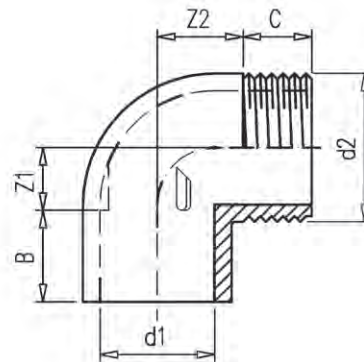

d1	d2	Z1	Z2	B	C	PN	pc/box
20	3/4" (M)	11	17	16	16	16	200
25	1" (M)	17	20	19	19	16	350
32	3/4" (M)	21	29	22	19	10	250
32	1" (M)	21	30	22	19	10	250
32	1 1/4" (M)	17	24	22	21	10	250
40	1 1/4" (M)	22	27	26	21	10	200
40	1 1/2" (M)	22	27	26	21	10	175
50	1 1/4" (M)	28	34	31	21	10	150
50	1 1/2" (M)	28	34	31	21	10	125
50	2" (M)	28	34	31	26	10	100

Bends PVC-U

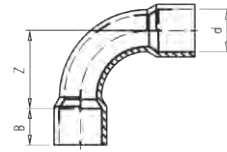

Bend 90° 32 - 50 mm $r = 1.8d$
63 - 315 mm $r = 1.5d$

d	Z	B (=max.tol +15%)	PN	pc/box
32	60	25	10	350
32	60	25	16	175
40	76	30	10	200
40	76	30	16	100
50	92	35	10	100
50	92	35	16	80
63	102	43	10	60
63	102	43	16	45
75	118	51	10	35
75	118	51	16	25
90	142	58	10	20
90	142	58	16	15
110	175	70	12.5	10
125	200	79	12.5	6
140	236	87	12.5	5
160	260	99	12.5	4
200	330	122	12.5	1
225	380	137	12.5	1
250	390	151	12.5	1
280	480	168	12.5	1
315	625	188	12.5	1

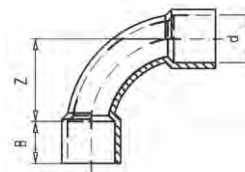

Bend 90° $r = 1.5d$

d	Z	B	PN	pc/box
20	30	16	16	100
25	37.5	19	16	100
32	48	22	16	100
32	48	22	10	100
40	60	26	16	100
40	60	26	10	100
50	75	31	16	50
50	75	31	10	50

Bends PVC-U

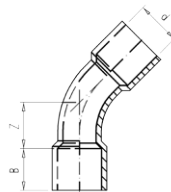

Bend 45° 32 - 50 mm $r = 1.8d$
63 - 315 mm $r = 1.5d$

d	Z	B (=max.tol +15%)	PN	pc/box
32	26	25	10	300
32	26	25	16	350
40	36	30	10	150
40	36	30	16	150
50	40	35	10	150
50	40	35	16	125
63	46	43	10	90
63	46	43	16	60
75	54	51	10	50
75	54	51	16	40
90	63	58	10	30
90	63	58	16	20
110	80	70	12.5	15
125	89	79	12.5	10
140	98	87	12.5	7
160	119	99	12.5	5
200	143	122	12.5	1
225	166	137	12.5	1
250	170	151	12.5	1
280	214	168	12.5	1
315	236	188	12.5	1

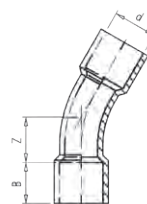

Bend 30° $r = 2.5d$

d	Z	B (=max.tol +15%)	PN	pc/Box
63	48	43	10	90
90	65	58	10	30
110	79	70	12.5	15
125	92	79	12.5	10
140	106	87	12.5	7
160	122	99	12.5	5
200	147	122	12.5	1
225	155	137	12.5	1
250	195	151	12.5	1
280	213	168	12.5	1
315	240	188	12.5	1

Bends PVC-U

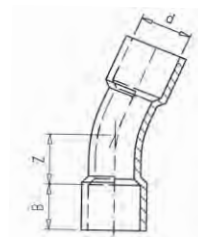

Bend 22.5°

d	Z	B (=max.tol +15%)	PN	pc / box
90	48	58	10	30
110	64	70	12.5	15
125	75	79	12.5	10
140	81	87	12.5	7
160	92	99	12.5	5
200	127	122	12.5	1

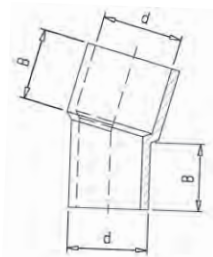

Bend 15°

d	B (=max.tol +15%)	PN	pc / box
90	51	12.5	30
110	61	12.5	18
125	69	12.5	20
140	76	12.5	10
160	86	12.5	6
200	106	12.5	2
225	119	12.5	1
250	131	12.5	1
280	141	12.5	1
315	164	12.5	1

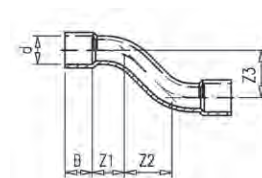

S-Bend

d	B	Z1	Z2	Z3	PN	pc/box
32	22	35	57	60	10	150
40	26	40	63	60	10	150
50	31	50	55	85	10	80

Bends PVC-U

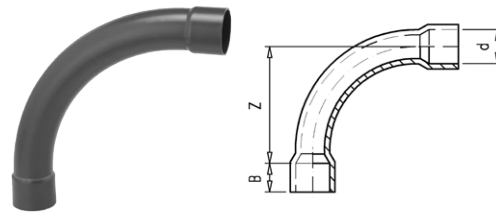

4-D Radius Bend 90° $r = 4d$

d	Z	B	PN	pc/box
63	256	50	10	30

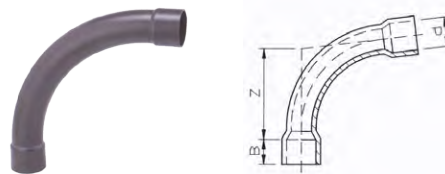

4-D Radius Bend 83° (97°) $r = 4d$

d	Z	B (=max.tol +15%)	PN	pc/box
63	227	50	10	30

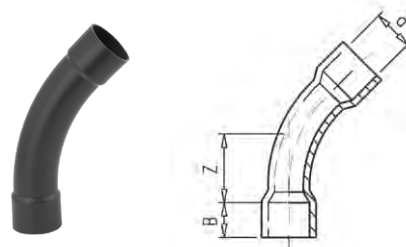

4-D Radius Bend 45° $r = 4d$

d	Z	B	PN	pc/box
63	159.5	50	10	50